

Viewed on approach from street

Note: Arbor height is determined by post height. Shown at 84" from grade to underside arbor clearance

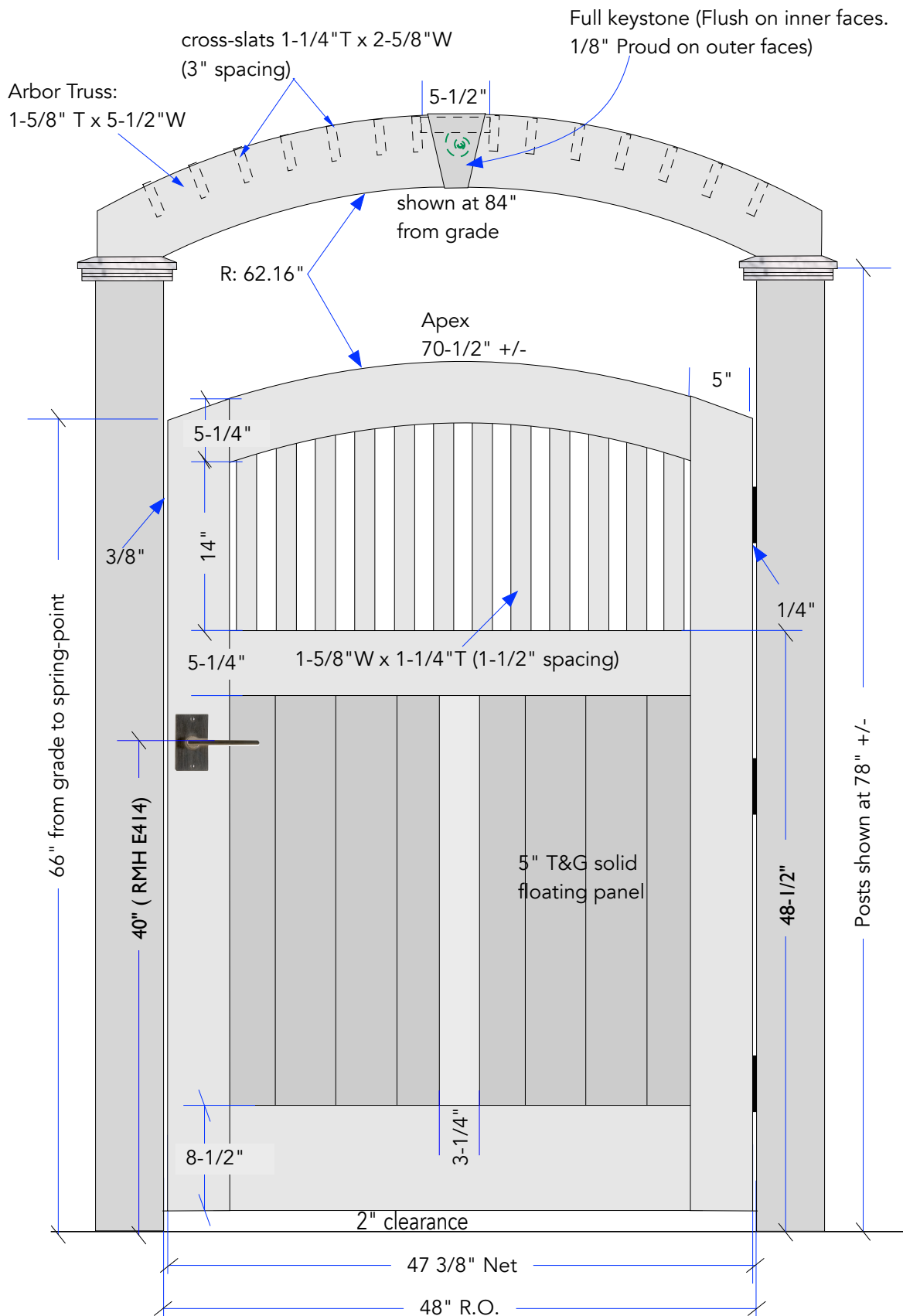

PO#2528--BARON -Gate 73-1. 1-5/8" thickness

PROWELL **W**OODWORKS
800.466.1850

Dated: June 23, 2025

Carefully review this drawing and noted specifications for you made-to-order product. Final approval is required before production can begin, at which point no returns or refunds will be granted. You will receive an e-signature link to transmit your final approval.

POSTS AND POST CAPS NOT INCLUDED

BARON --- PRODUCT SPECIFICATIONS /

Product: Dutch Gate: Style #73-1
Material: Clear Western Cedar
Construction: Mortise and Tenon
Dimension: R.O: 48" X 66" from grade to spring-point
Thickness: 1-5/8"
Jambs: No
Swing Direction: ?? SEE BELOW

Hardware:
-RMH Metro latch e414
Hinges: 4.5" ball-bearing (3))
Finish: No
Deliver to: Mill Valley, CA
Notes:

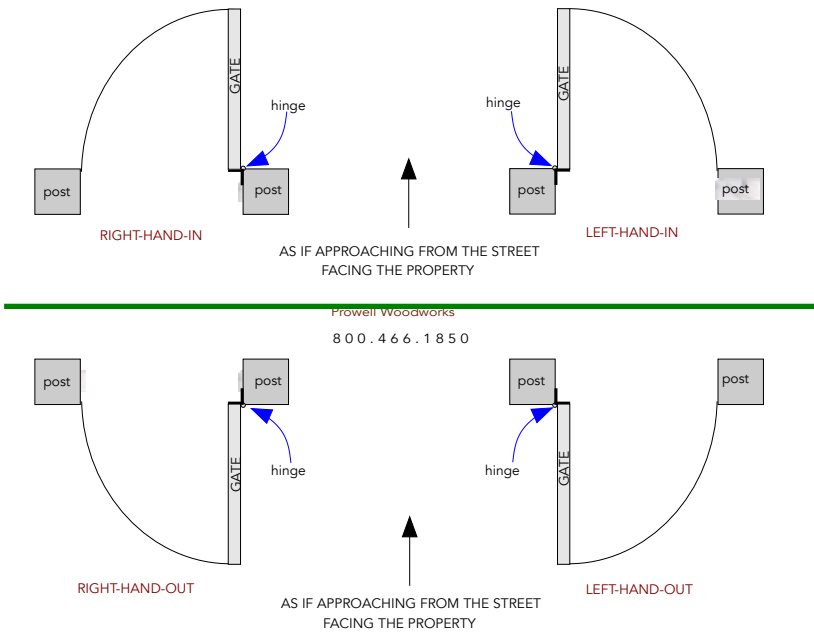

Note: The ultimate height of the arbor truss is determined by the height of the posts.

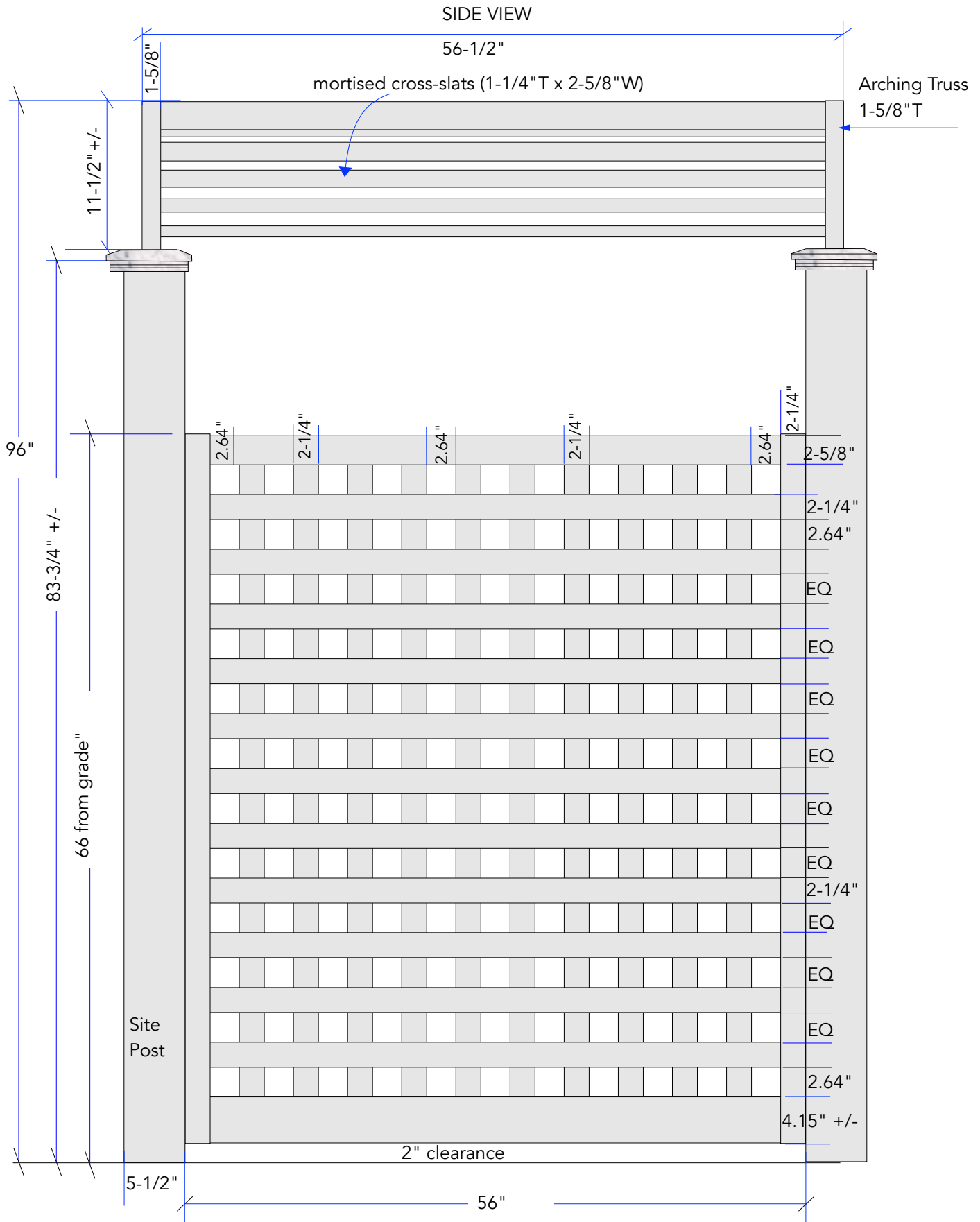

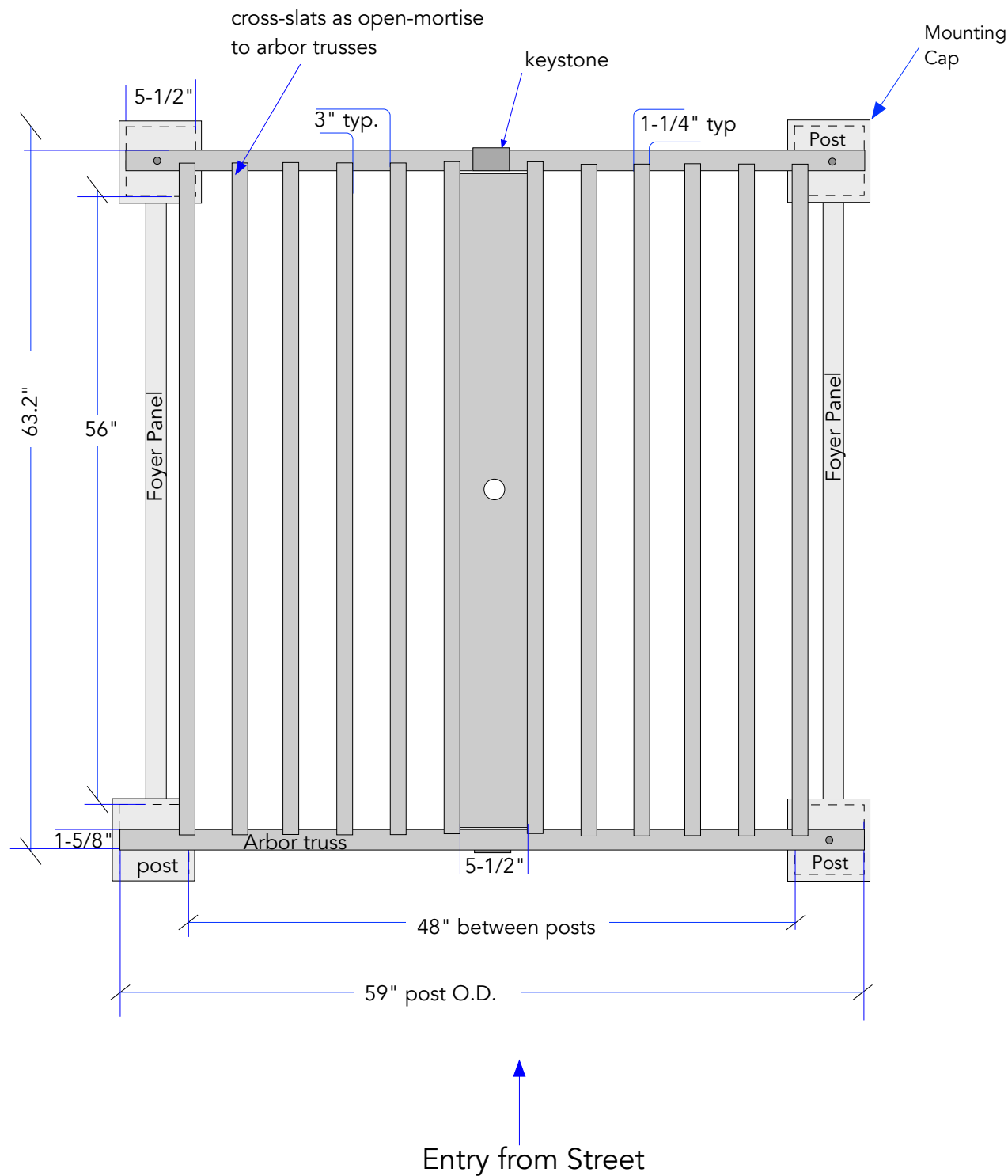

ELEVEN (11) IDENTICAL PANELS

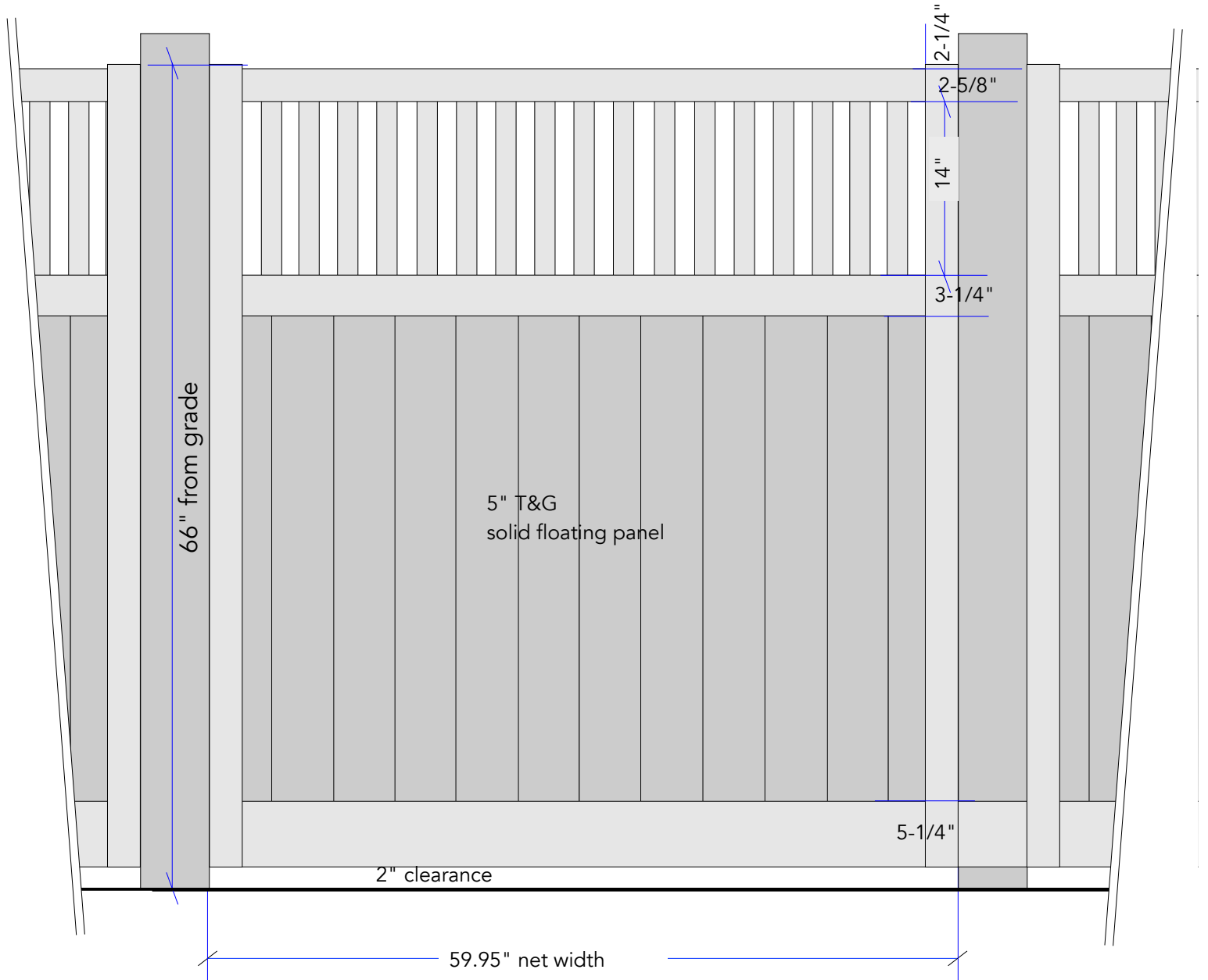

ONE PANEL 44" NET WIDTH

