

PO#2608-LIND.

PROWELL Woodworks
800.466.1850

TRASH PANEL. Style #16-5. 1-5/8" T

Dated: April 1, 2026

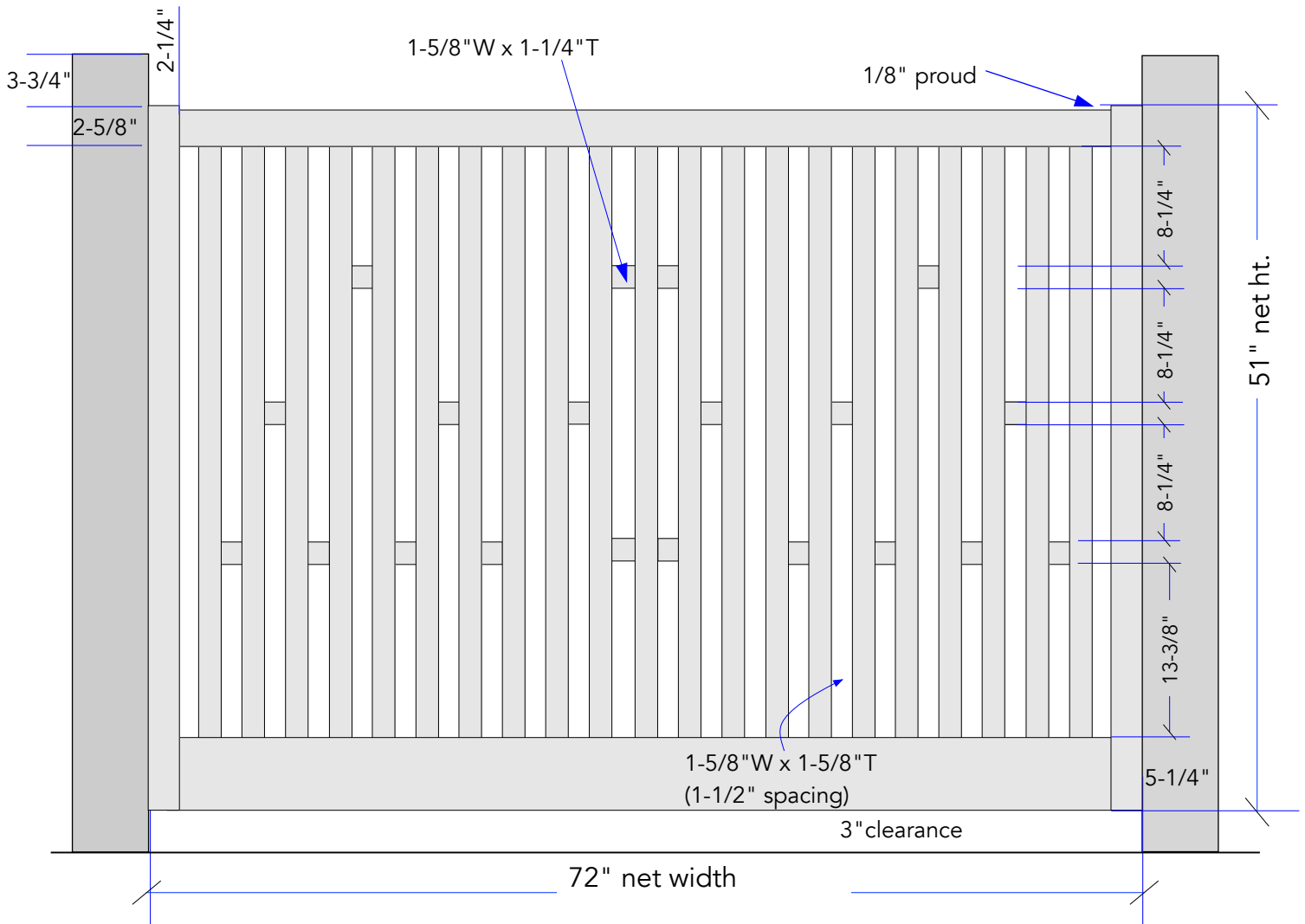

PO#2608-LIND.

Dated: April 1, 2026

PROWELL Woodworks
800.466.1850

GARDEN GATE. Style #3-4. 2-1/4" T

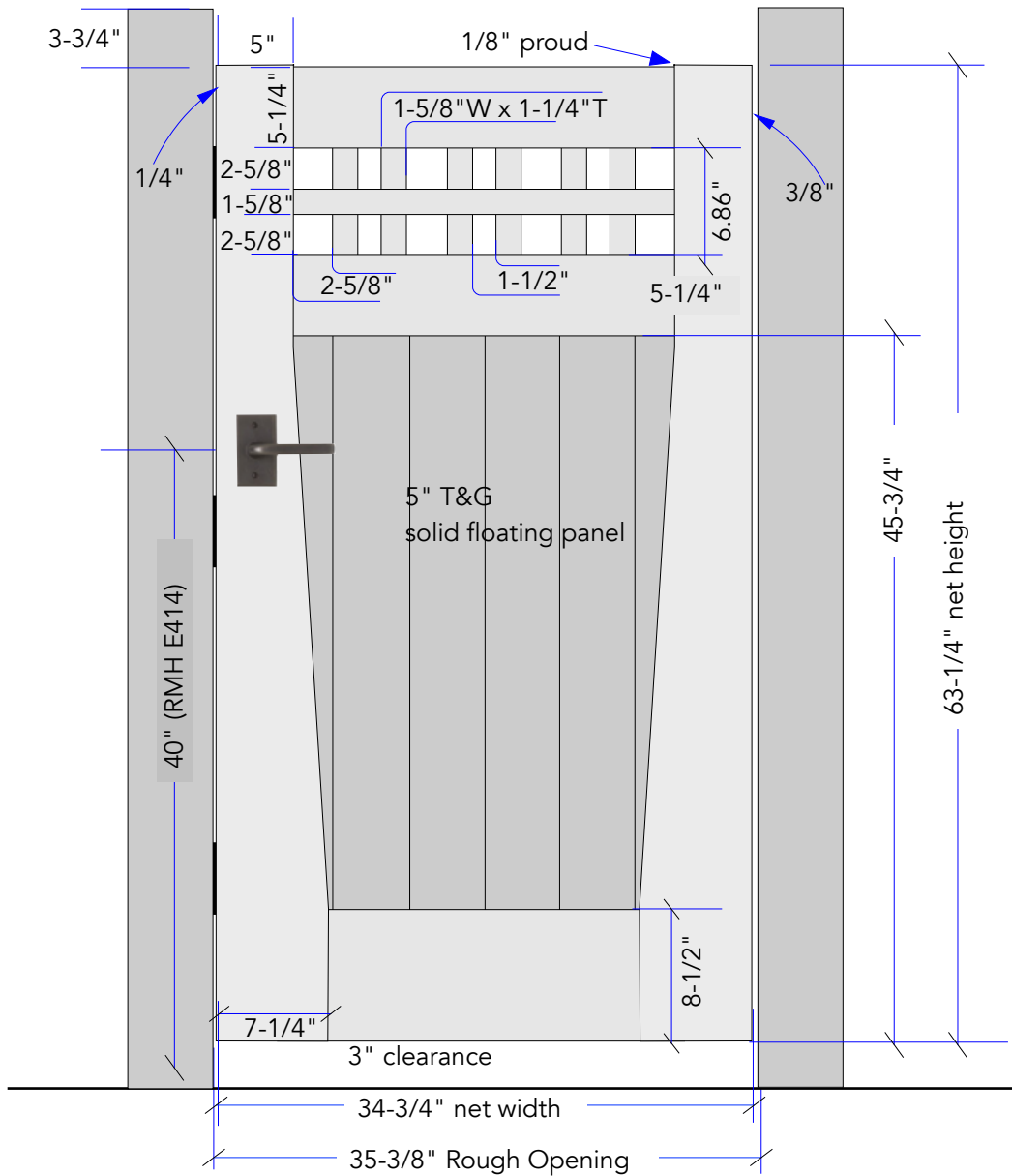

GARDEN GATE #3-4

Carefully review this drawing and noted specifications for you made-to-order product. Final approval is required before production can begin, at which point no returns or refunds will be granted. You will receive an e-signature link to transmit your final approval.

POSTS AND POST CAPS NOT INCLUDED

LIND---PRODUCT SPECIFICATIONS / NOTES

Product: Gate Style #3-4(tapered stiles)
Material: Clear KD Western Cedar VG
Construction: Mortise and Tenon
Dimension: R.O: 35-3/8" X 63-1/4 net ht
Thickness: 2-1/4"
Swing Direction: Left-Hand-In

Latch: RMH E236 SBD
Hinge: 4.5" ball-bearing (3)
Finish: No
Lead Time: Approx 8 wks from approval
Ship To: Mount Pleasant, SC
Notes:

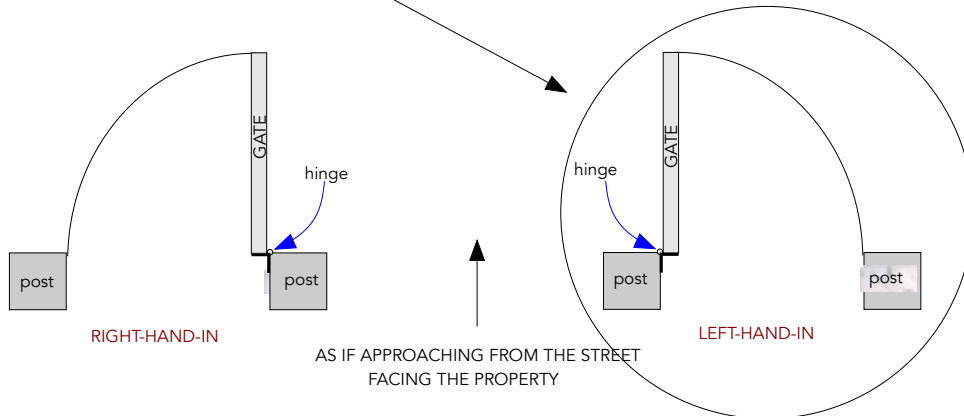

PROWELL WOODWORKS
800.466.1850

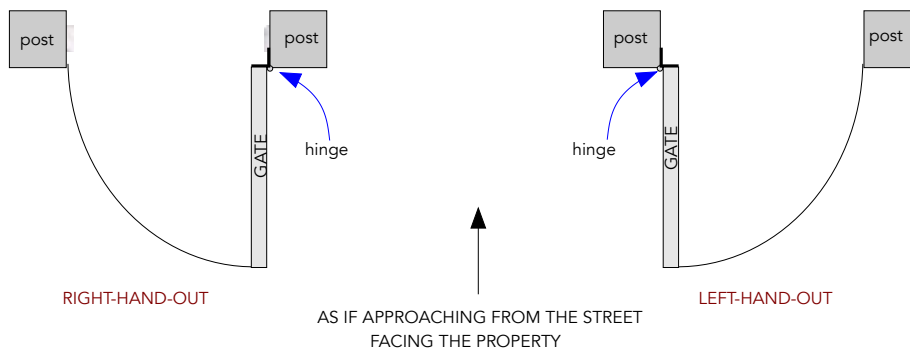

WALL TRELLIS (2 Count).
Style #19. 1-5/8" T

Grids: 9.1" sq

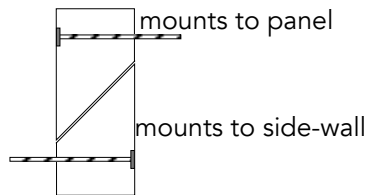
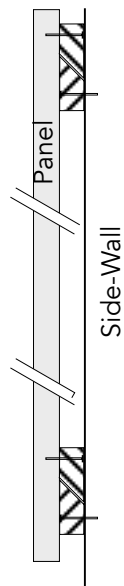
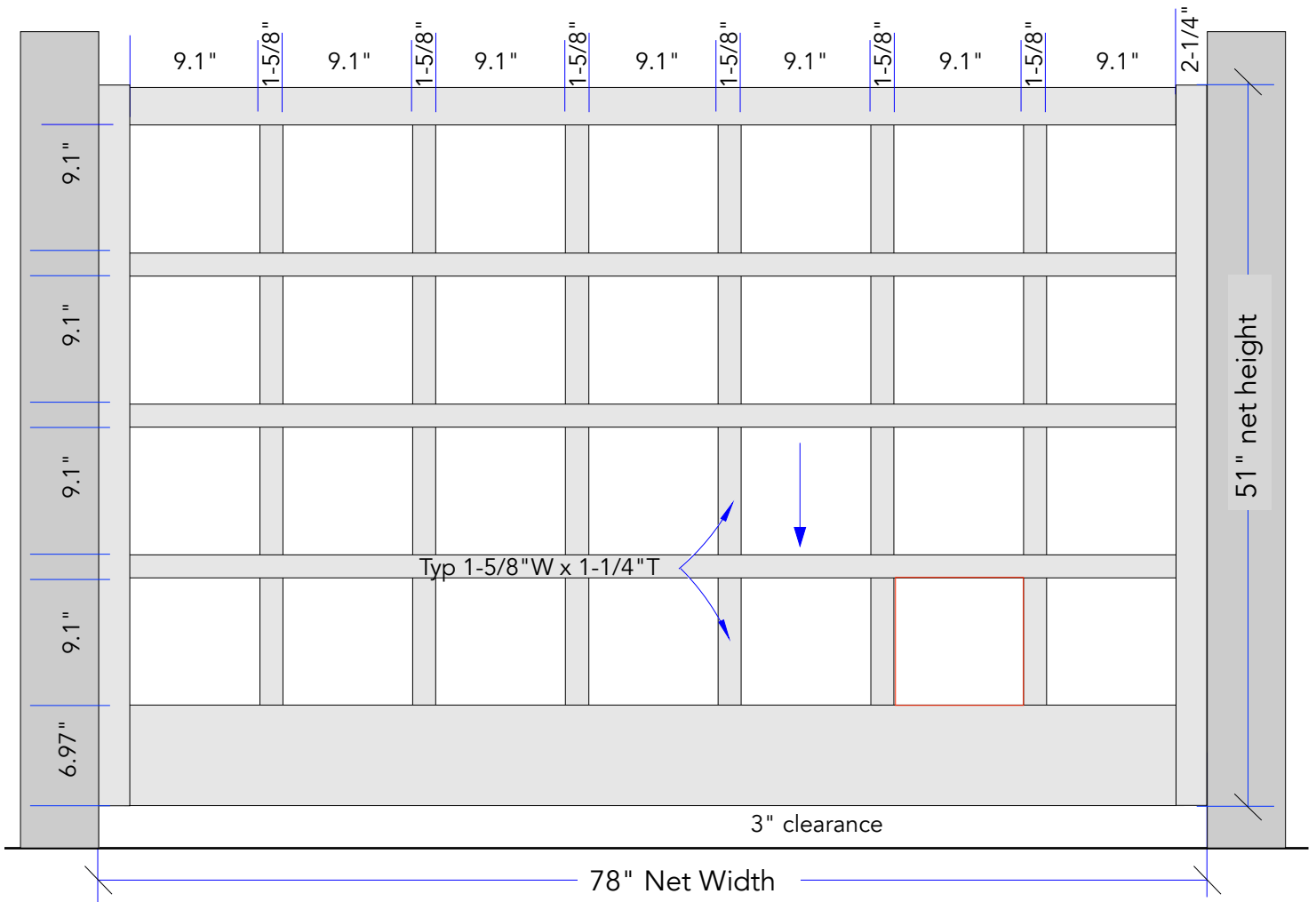

Lift-Off Cleat

MECHANICAL SCREENS (3 total panels).
Fence Style #16-5. 1-5/8" T

SECTION A. 120" O.D. POST TO POST
(2 count at 51-3/4" net width x 69" net ht.

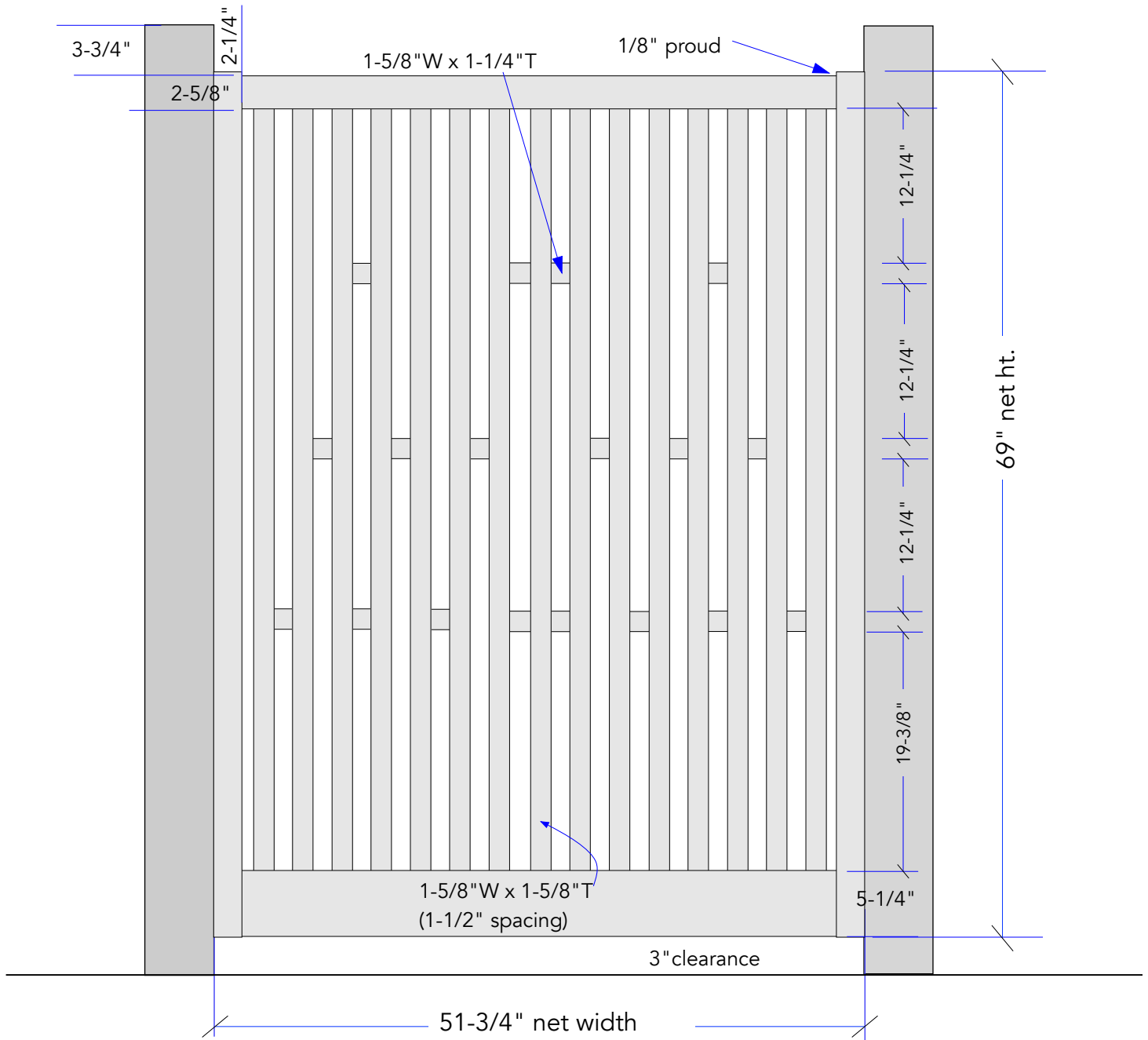

MECHANICAL SCREENS (1 total panel).
Fence Style #16-5. 1-5/8" T

SECTION B. 75" O.D. POST TO POST
(1 count at 64" net width x 69" net ht.)

